

Data Sheet

Free Standing Mono-Pitch Canopy



Features and Benefits

- Classification Accredited to BS EN 1090
- Load tested to BS EN 1991003:2003
- Certified Non-Fragile to ACR[M] 2014:001 Class C
- Constructed from 6063 T6 grade aluminium
- Integral gutter
- Integral downpipe
- Available with polycarbonate or glass roof
- All materials used are fully recyclable
- Life expectancy of at least 40 years
- 10 year warranty
- Choice of radius or straight fascia

Free Standing Mono-Pitch Canopy

A self supporting canopy roof system constructed from high-grade aluminium with polycarbonate or laminated glass roof panels. The canopy is bolted to a concrete foundation.

Size Parameters

- Any length
- Max projection: 6m (polycarbonate roof) and 5m (glass roof)

Maximum Span Between Canopy Posts

Material	Canopy Projection				
	2m	3m	4m	5m	6m
POLYCARBONATE	6m	5m	5m	4m	4m
GLASS	5m	4m	4m	4m	

Roof Panels

Polycarbonate:

- 16mm multiwall in clear or opaque finish. Max width 980mm
- Weight: 2.7kg/m²
- UV transmittance: Clear - 85%, Opaque - 42%
- Fire rating: BS476-7 Class1Y
- Other colours available upon inquiry

Glass:

- 8.76mm laminate in clear finish. Max width 850mm
- Weight: 20.8kg/m²
- Light transmittance: 98%
- Fire rating: EN12600 Class1B1

Frame

- 6063-T6 grade aluminium powder coated in RAL7016 Anthracite Grey or RAL9016 White as standard. Other RAL colours available to order
- Certified to BS EN1090
- Classified 'Non-Fragile' to ACR [M]001:2014 Class C



Side Elevation

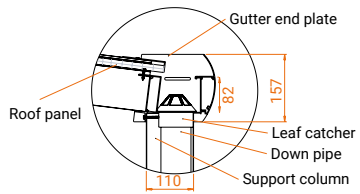

DETAIL A - RADIUS FASCIA

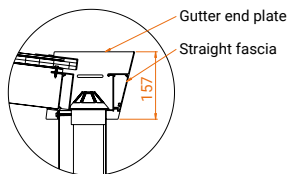

DETAIL A - STRAIGHT FASCIA

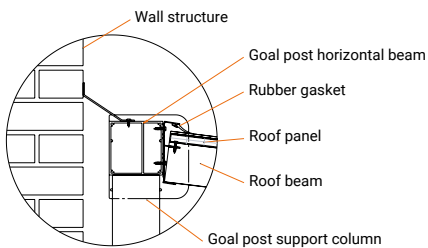

DETAIL B

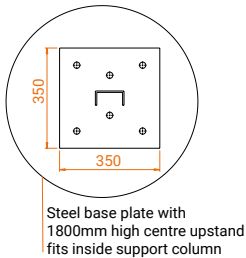

DETAIL C

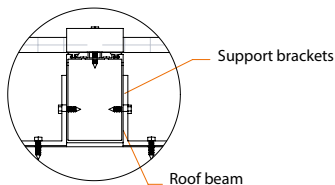

DETAIL D

Option 1

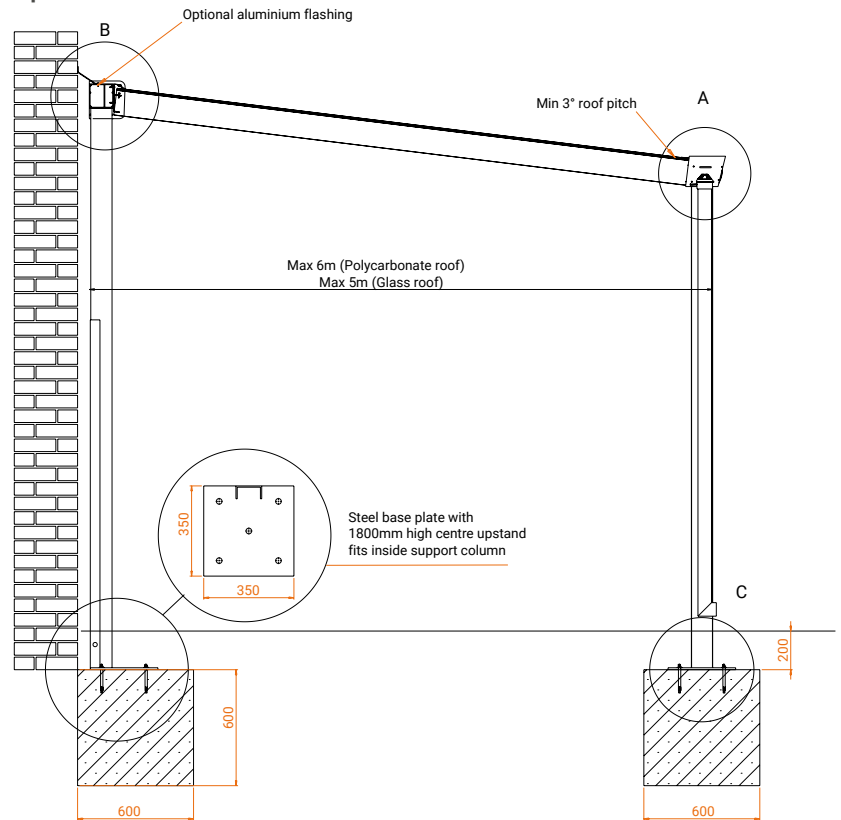

Option 2

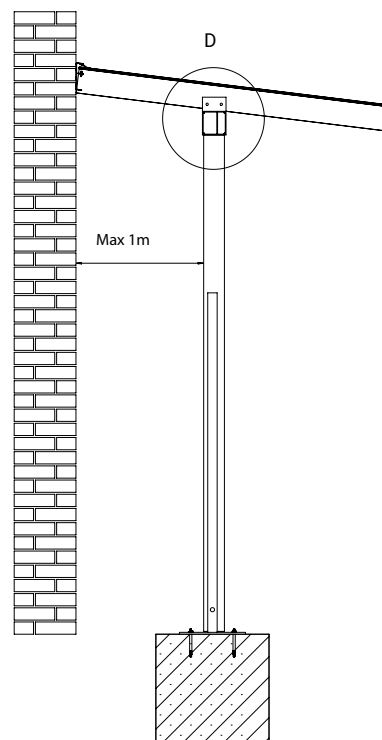

Front Elevation

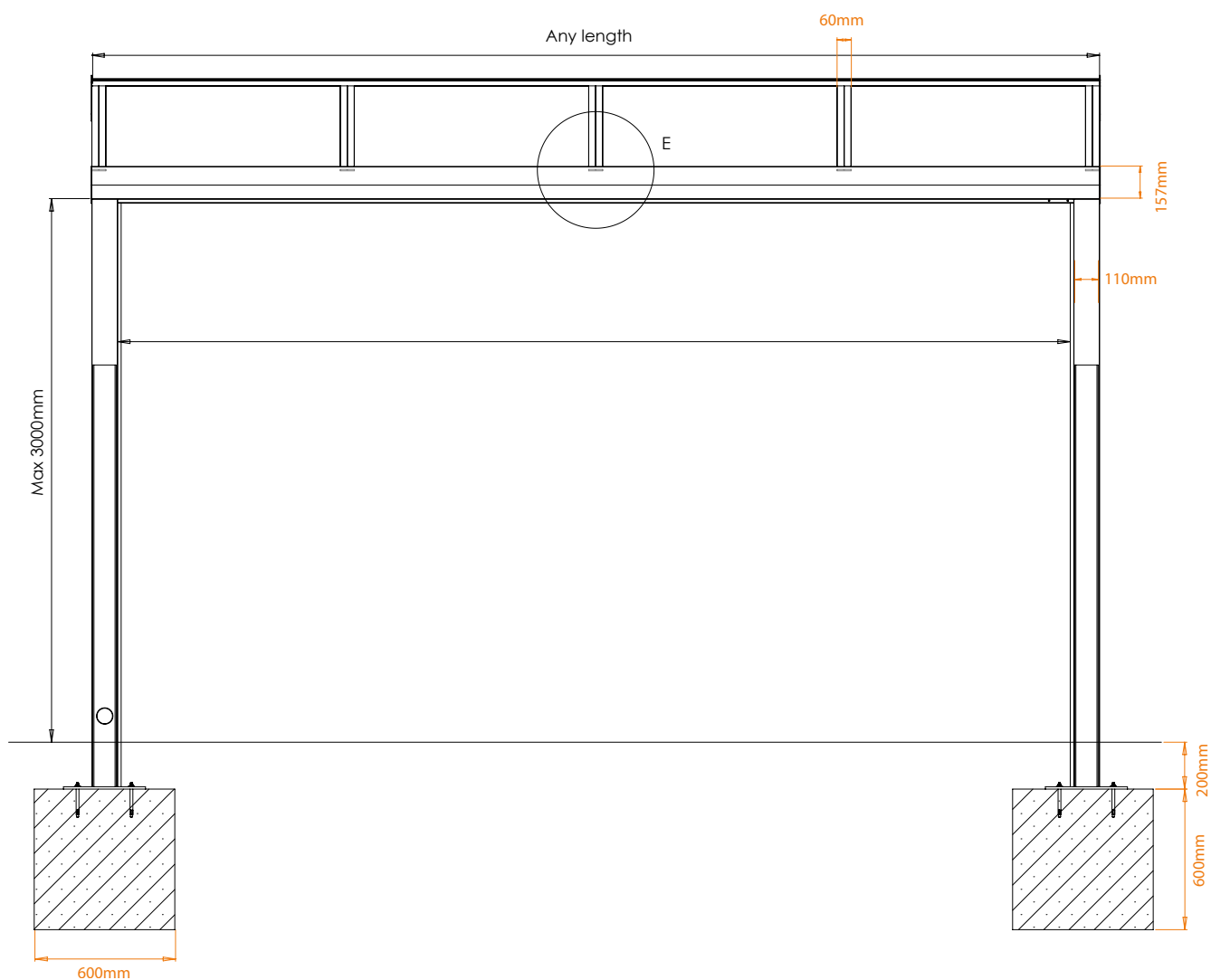
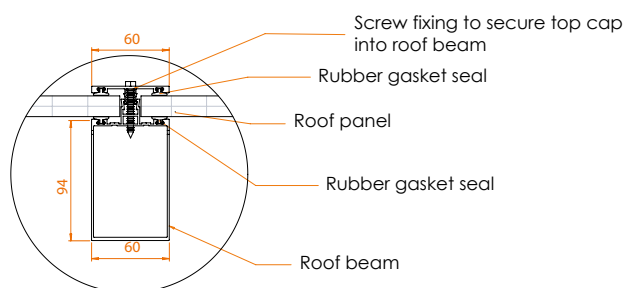

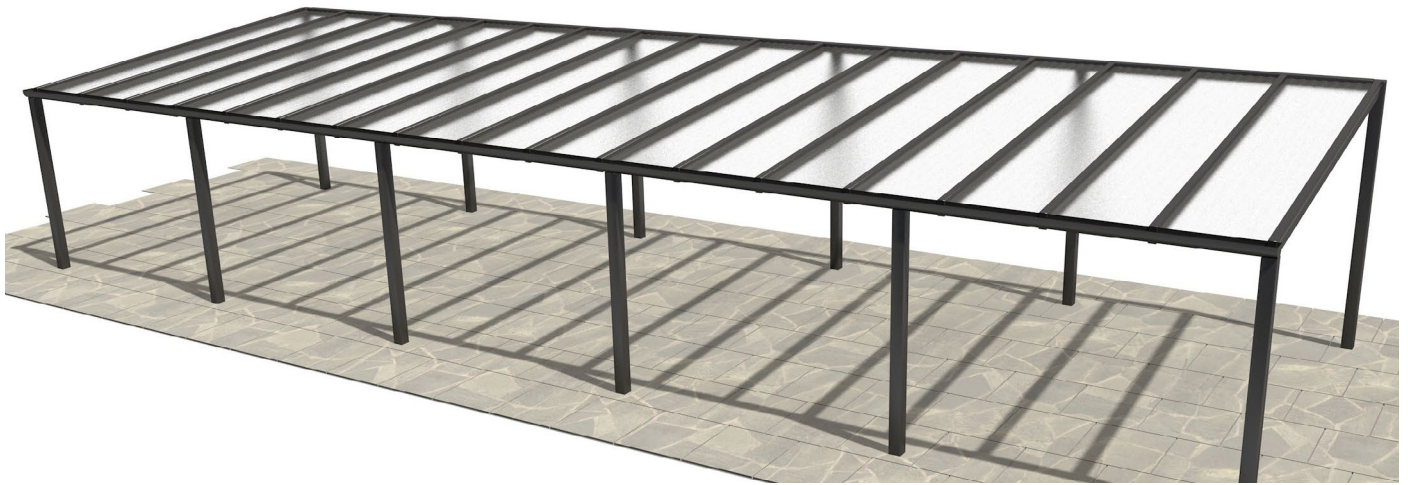

Basic Specification Wording

WeatherSpan® aluminium Free Standing Mono-Pitch Canopy with integral rainwater drainage system. Size: length x projection (mm). Roof sheets to be 16mm multi-wall polycarbonate or 8.8mm laminated safety glass.

Gutter fascia to be radiused/angled. PVC rainwater downpipes concealed inside front support posts with outlet either above ground or below ground where it will connect to existing sub terrain drainage pipework by others.

Support post along the front and back edges are 110mm x 110mm square and fixed below the finished floor level to steel anchor plates bolted to concrete foundations provided by others (The typical foundation size is 600mm x 600mm x 600mm).

Optional bespoke aluminium flashing folded to suit, to provide enhanced weather protection between the back of the canopy and any adjacent building.

All aluminium is 6063-T6 grade. Canopy system is accredited to BS-EN1090 and covered by a 10-year manufacturer's warranty.

Maintenance

Annual cleaning of roof and frame with brush and clean water is recommended. Gutters should be cleaned at least twice a year.

Life Expectancy & Warranty

WeatherSpan® canopies have a life expectancy of at least 40 years. The canopy carries a 10 year warranty.